

Both systems are symmetrical couplings. Type Gost is used in the fire fighting field and type Rotta mainly on ships. Type Gost has got 2 lugs, consists of two parts, is swivelling and suitable for delivery- and suction operation. Type Rotta has 3 lugs, consists of one part is non-swivelling and only suitable for delivery operation.

- Aluminium alloys (A)
- Copper alloys (C)

Hose couplings Gost



1050 A

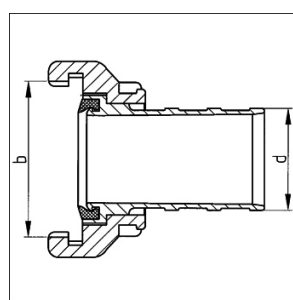

1050 A

Nominal size	Lug spacing b (mm)	For hose i. d. D (mm)	Weight (kg)	Ident.No.	Remarks	Alloy
50	78	38	0,245	60595233		A
50	78	52	0,280	40419633		A
50	78	52	1,000	40419695		A
70	95	65	0,480	40416233		A
70-DS	95	65	0,480	40416201		A
70	95	64	1,700	40416295		A
80	107	75	0,650	30336333		A
80-DS	107	75	0,700	30336301		A
80	107	75	2,120	30336395		A
100	140	101	1,000	60543933		A
100-DS	140	101	1,170	60543901		A
100	140	101	3,000	60543995		A
125	166	125	1,760	30391133		A
125-DS	166	125	1,760	30391201		A

Nominal size	Lug spacing b (mm)	For hose i. d. D (mm)	Weight (kg)	Ident-No.	Remarks	Alloy
150-DS	176	150	2,450	30391233		A

Other sizes and styles on request.