

Both systems are symmetrical couplings. Type Gost is used in the fire fighting field and type Rotta mainly on ships. Type Gost has got 2 lugs, consists of two parts, is swivelling and suitable for delivery- and suction operation. Type Rotta has 3 lugs, consists of one part is non-swivelling and only suitable for delivery operation.

- Aluminium alloys (A)
- Copper alloys (C)

Hose couplings Rotta (Roth)



1050 B

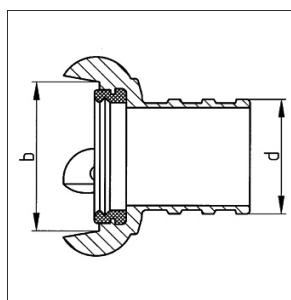

1050 B

Nominal size	Lug spacing (mm)	For hose i. d. D (mm)	Weight (kg)	Ident.No.	Alloy
50	67	38	0,680	60296895	A
50	67	52	0,720	30334695	A
70	84	38	1,100	60296995	A
70	84	52	1,200	60297095	A
70	84	65	1,300	30334995	A