

Couplings according British Standard BS 336

A non-symmetrical quick connection coupling with a male and female part. These couplings are only suitable for delivery operation. For suction operation round thread couplings are in use.

- Aluminium alloys (A)
- Copper alloys (C)

Seals for Instantaneous couplings

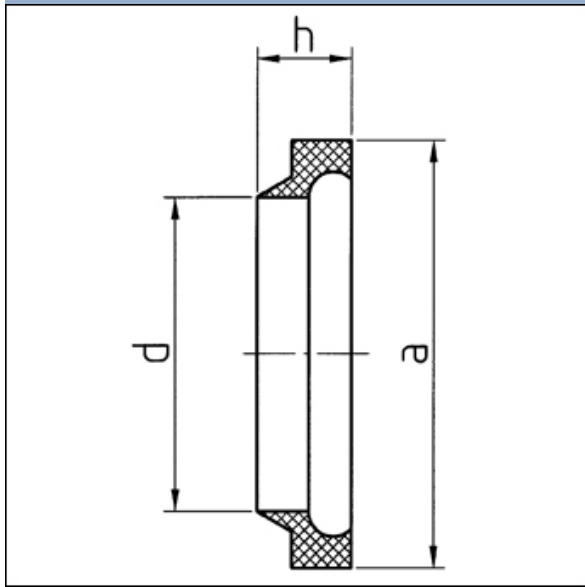

1713

Nominal size (inch)	Pieces per bag	a x d x h (mm)	Weight per bag (kg)	Ident.No.	Remarks	Alloy
1 ½"	20	50,3 x 31,6 x 13,2	0,200	60201451		A
2 ½"	20	77,8 x 57,1 x 17,3	0,450	60201051		A