

Symmetrical quick connection coupling, no female and male part, no problem with matching hose ends. Assembly and functionality of couplings Storz System.

Quick connection couplings with DS suffix generally are suitable for delivery and suction operation, without DS suffix for delivery operation only.

Working pressure is PN 16 if not mentioned otherwise.

- Aluminium alloys (A)
- Copper alloys (C)
- High grade steel (St)

Hose couplings with Internal Binding



1005 A

For binding sturdy, heavy-wall rubber hoses of nominal sizes 25 to 33 mm. The inside diameter of the hose is with this design hardly reduced in the coupling passage, and therefore offers particularly good flow conditions.

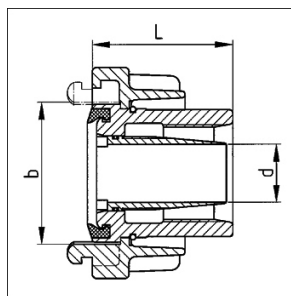

1005 A

Nominal size	Lug spacing b (mm)	For hose i. d. (mm)	Inside dia. tail piece	Length (mm)	Weight (kg)	Ident.No.	Remarks	Alloy
52=C	66	S 25 x 6	24	65	0,510	40404733		A
52=C	66	S 33 x 8	30	65	0,520	40274033		A